

## PW9219

| NO. | DESCRIPTION                  |
|-----|------------------------------|
| A1  | CAP                          |
| A2  | DETERGENT TANK               |
| A3  | WATER INLET CONNECTOR&FILTER |
| A4  | BACK HOUSING                 |
| A5  | WHEEL                        |
| A6  | MOTOR&PUMP ASSY              |
| A7  | WHEEL COVER                  |
| A8  | GUN HOLDER                   |
| A9  | CABLE JACKET                 |
| A10 | CABLE PRESS PLATE            |
| A11 | SCREW                        |
| A12 | POWER CABLE                  |
| A13 | SWITCH KNOB                  |
| A14 | FRONT HOUSING                |
| A15 | PRESSURE HOSE                |
| A16 | CLEANING PIN                 |
| A17 | BUTTON                       |
| A18 | FRONT DECORATIVE PLATE       |
| A19 | ADJUSTABLE NOZZLE            |
| A20 | GUN                          |
| A21 | HANDLE SLEEVE                |
| A22 | HANDLE                       |
| A23 | SCREW                        |
| A24 | HOSE HOOK                    |
| A25 | WARNING LABEL                |
| A26 | RATING LABEL                 |
| A27 | POWER CABLE HOOK             |
| A28 | ACCESSORIES HOLD             |
| A29 | DETERGENT TUBE               |

RU-ST20161128  
VER:2.1

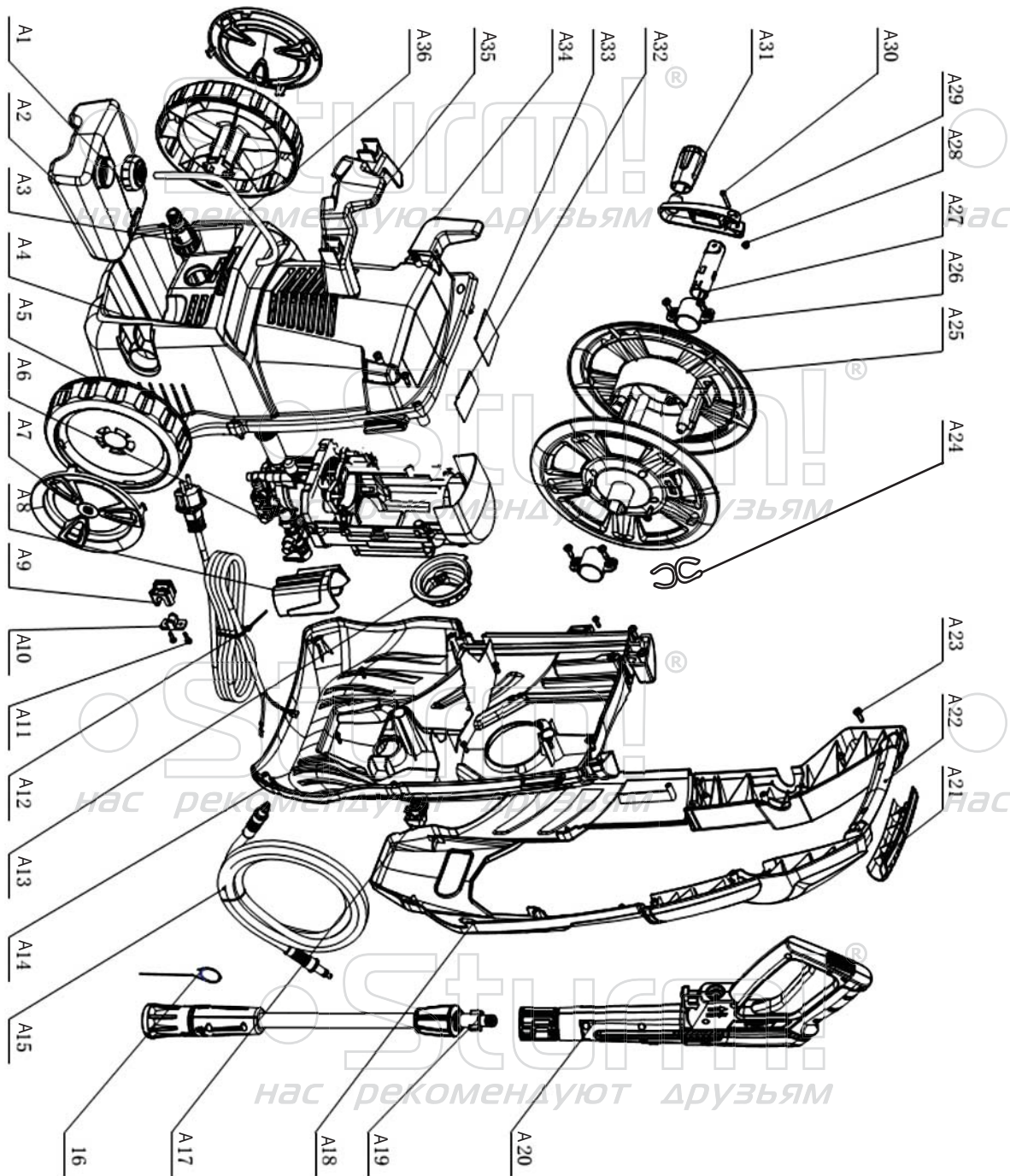

## PW9223

| NO. | DESCRIPTION                  |
|-----|------------------------------|
| A1  | CAP                          |
| A2  | DETERGENT TANK               |
| A3  | WATER INLET CONNECTOR&FILTER |
| A4  | BACK HOUSING                 |
| A5  | WHEEL                        |
| A6  | MOTOR&PUMP ASSY              |
| A7  | WHEEL COVER                  |
| A8  | GUN HOLDER                   |
| A9  | CABLE JACKET                 |
| A10 | CABLE PRESS PLATE            |
| A11 | SCREW                        |
| A12 | POWER CABLE                  |
| A13 | SWITCH KNOB                  |
| A14 | FRONT HOUSING                |
| A15 | PRESSURE HOSE                |
| A16 | CLEANING PIN                 |
| A17 | BUTTON                       |
| A18 | FRONT DECORATIVE PLATE       |
| A19 | ADJUSTABLE NOZZLE            |
| A20 | GUN                          |
| A21 | HANDLE SLEEVE                |
| A22 | HANDLE                       |
| A23 | SCREW                        |
| A24 | PRESSURE WASHER CLIP         |
| A25 | HOSE REEL                    |
| A26 | HOSE REEL BRACKET            |
| A27 | HOSE REEL AXIS               |
| A28 | CAP NUT                      |
| A29 | ROCKING HANDLE               |
| A30 | SCREW                        |
| A31 | ROCKING HANDLE SLEEVE        |
| A32 | WARNING LABEL                |
| A33 | RATING LABEL                 |
| A34 | POWER CABLE HOOK             |
| A35 | ACCESSORIES HOLDER           |
| A36 | DETERGENT TUBE               |

RU-ST20161128  
VER:2.1

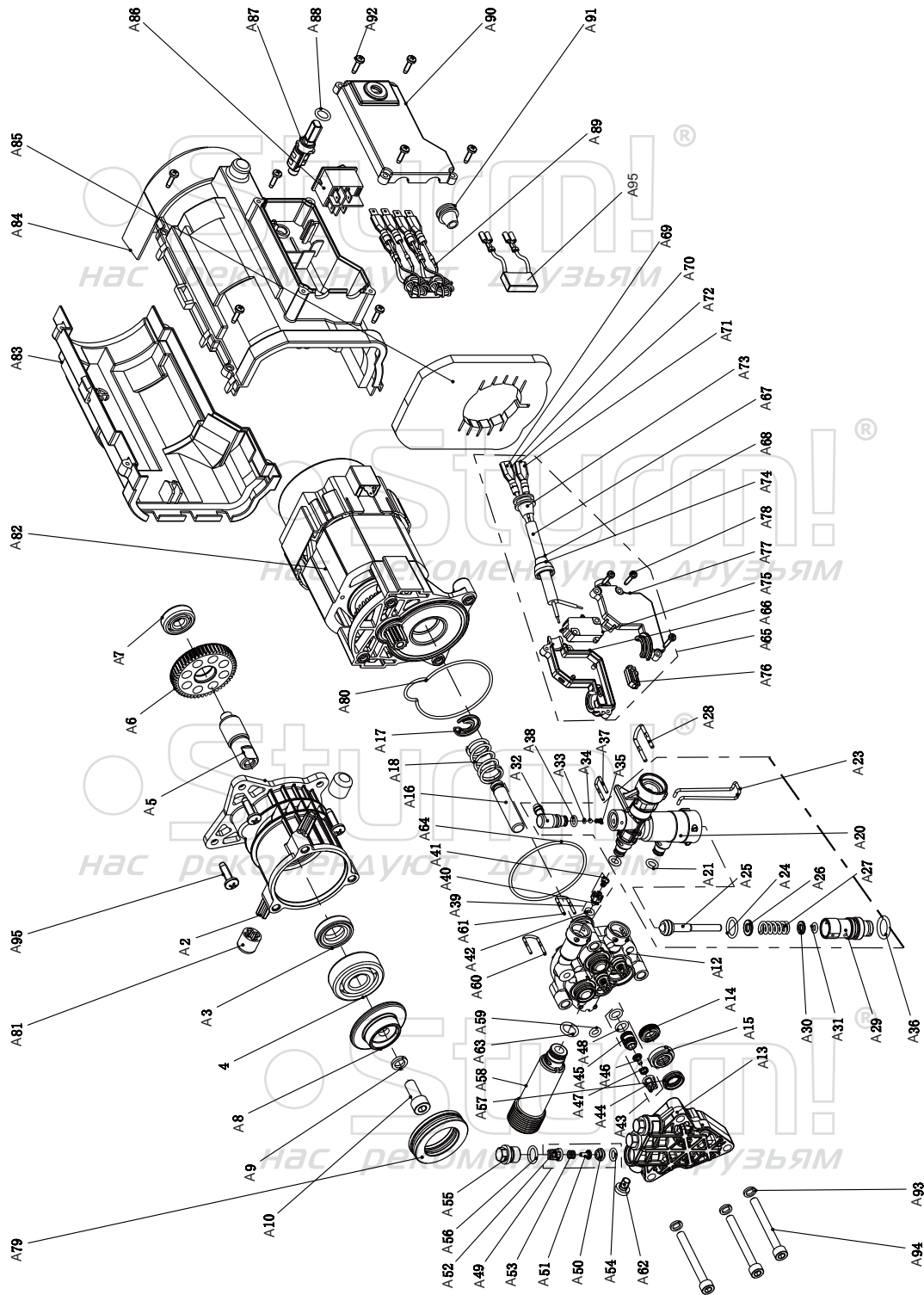

## PUMP FOR PW9219 PW9223

| NO. | DESCRIPTION                | NO. | DESCRIPTION               |
|-----|----------------------------|-----|---------------------------|
| A2  | OIL CYLINDER               | A51 | CHECKING VALVE CORE       |
| A3  | OIL SEAL 30X17X7           | A52 | CHECKING VALVE BRACKET    |
| A4  | BEARING 6302Z              | A53 | CHECKING VALVE SPRING     |
| A5  | GEAR SHAFT                 | A54 | O RING 6X1.8              |
| A6  | BIG GEAR                   | A55 | CHECKING VALVE CAP        |
| A7  | BEARING 629-2Z             | A56 | O RING 9.5X1.8            |
| A8  | SWASH PLATE                | A57 | OIL SEAL 10X16X4          |
| A9  | GASKET 8                   | A58 | INLET HOSE                |
| A10 | BLOT M8X20                 | A59 | O RING 5.5X2              |
| A12 | PUMP BODY                  | A60 | U PIN                     |
| A13 | PUMP COVER                 | A61 | U PIN                     |
| A14 | PLUNGER OIL SEAL 10X16X4   | A62 | BOLT M6X8                 |
| A15 | OIL SEAL BRACKET           | A63 | O RING 10X2.2             |
| A16 | PLUNGER                    | A64 | O RING 58X2               |
| A17 | PLUNGER CHUCK              | A65 | ON-OFF SWITCH ASSY        |
| A18 | PLUNGER SPRING             | A66 | SWITCH-DOWN COVER         |
| A20 | OUTLET HOSE                | A67 | SWITCH WIRE ASSY          |
| A21 | O RING 5.5X2               | A68 | SWITCH WIRE               |
| A23 | BAYONET LOCK               | A69 | FEMALE TERMINAL           |
| A24 | O RING 12X2                | A70 | COVER FOR FEMALE TERMINAL |
| A25 | RELIEF VALVE CORE          | A71 | MALE TERMINAL             |
| A26 | LIMIT RING                 | A72 | COVER FOR MALE TERMINAL   |
| A27 | RELIEF VALVE SPRING        | A73 | COVER FOR OUTLET WIRE     |
| A28 | U PIN                      | A74 | COVER FOR SWITCH          |
| A29 | RELIEF VALVE CAP           | A75 | ON-OFF SWITCH(WELDED)     |
| A30 | RELIEF VALVE GASKET        | A76 | ON-OFF SWITCH PUSH ROD    |
| A31 | O RING 4.5X1               | A77 | SWITCH-UP COVER           |
| A32 | SIPHON ELBOW               | A78 | BOLT ST2.9X13             |
| A33 | O RING                     | A79 | BEARING 51106             |
| A34 | STAINLESS STEEL BALL       | A80 | SEAL RING                 |
| A35 | SIPHON SPRING              | A81 | DAMPING RING              |
| A36 | O RING 12X2.5              | A82 | MOTOR                     |
| A37 | U PIN                      | A83 | FAN COVER DOWN            |
| A38 | O RING                     | A84 | FAN COVER UP              |
| A39 | BACK PRESSURE VALVE ASSY   | A85 | FAN COVER FILTER          |
| A40 | BACK PRESSURE VALVE CORE   | A86 | MAIN SWITCH               |
| A41 | BACK PRESSURE VALVE SPRING | A87 | SWITCH DRIVING LEVER      |
| A42 | O RING 3.5X1.9             | A88 | O RING 8X2                |
| A43 | INLET CHECKING VALVE ASSY  | A89 | INDUCTANCE ASSY           |
| A44 | CHECKING VALVE BRACKET     | A90 | SWITCH COVER              |
| A45 | INLET CHECKING VALVE SEAT  | A91 | OUTLET WIRE COVER         |
| A46 | CHECKING VALVE CORE        | A92 | BOLT ST3.5 X13F           |
| A47 | CHECKING VALVE SPRING      | A93 | GASKET 6                  |
| A48 | O RING 6X1.8               | A94 | BOLT M6X55                |
| A49 | OUTLET CHECKING VALVE ASSY | A95 | CAPACITOR ASSY            |
| A50 | CHECKING VALVE SEAT        |     |                           |